



• Artistic Impression

- **48 M<sup>2</sup> LIVING SPACE, 120 M<sup>2</sup> SHED SPACE --- TOTAL 168 M<sup>2</sup> FLOOR SPACE**
- **KITSET\* AVAILABLE FROM - \$114,730 INCL GST - \$ 683 / M<sup>2</sup>**
- **BUILDING\*\* ERECTED TO LOCKUP STAGE FROM - \$225,255 INCL GST - \$ 1,341 / M<sup>2</sup>**

### INCLUDES-

- ✓ Concept Plans to Full Design - Kit or Build
- ✓ NZ Steel for Strength and Durability
- ✓ NZ Made - Double Glazed Joinery - Low E Xcel
- ✓ Colorsteel™ Maxam Corrugate Cladding
- ✓ NZ Made Coloursteel Roller Doors
- ✓ Built to withstand High Wind Zone of 45 m/s
- ✓ Internal Wall Framing
- ✓ We can take care of All building & Resource Consents - Kit / Build
- ✓ 50 year - Structural & Cladding Guarantee (site dependent)
- ✓ 100 % NZ Owned and Operated
- ✓ Fully Compliant to NZ Building Code



### CONTACT US:

 0800 555 147

 218 Hunter Road, Eureka

 Enquiries@waikatosheds.co.nz

 www.waikatosheds.co.nz

#### Please Note -

\*Kitset and Build **Do Not** include : - section, internal fit-out, appliances, septic field & water tanks, earthworks & metal driveway, concrete apron & path, council fees, soil, storm and waste water reports.

\*\*Build includes construction, concrete slab and external finish

# American Barn House - 1 Bedroom

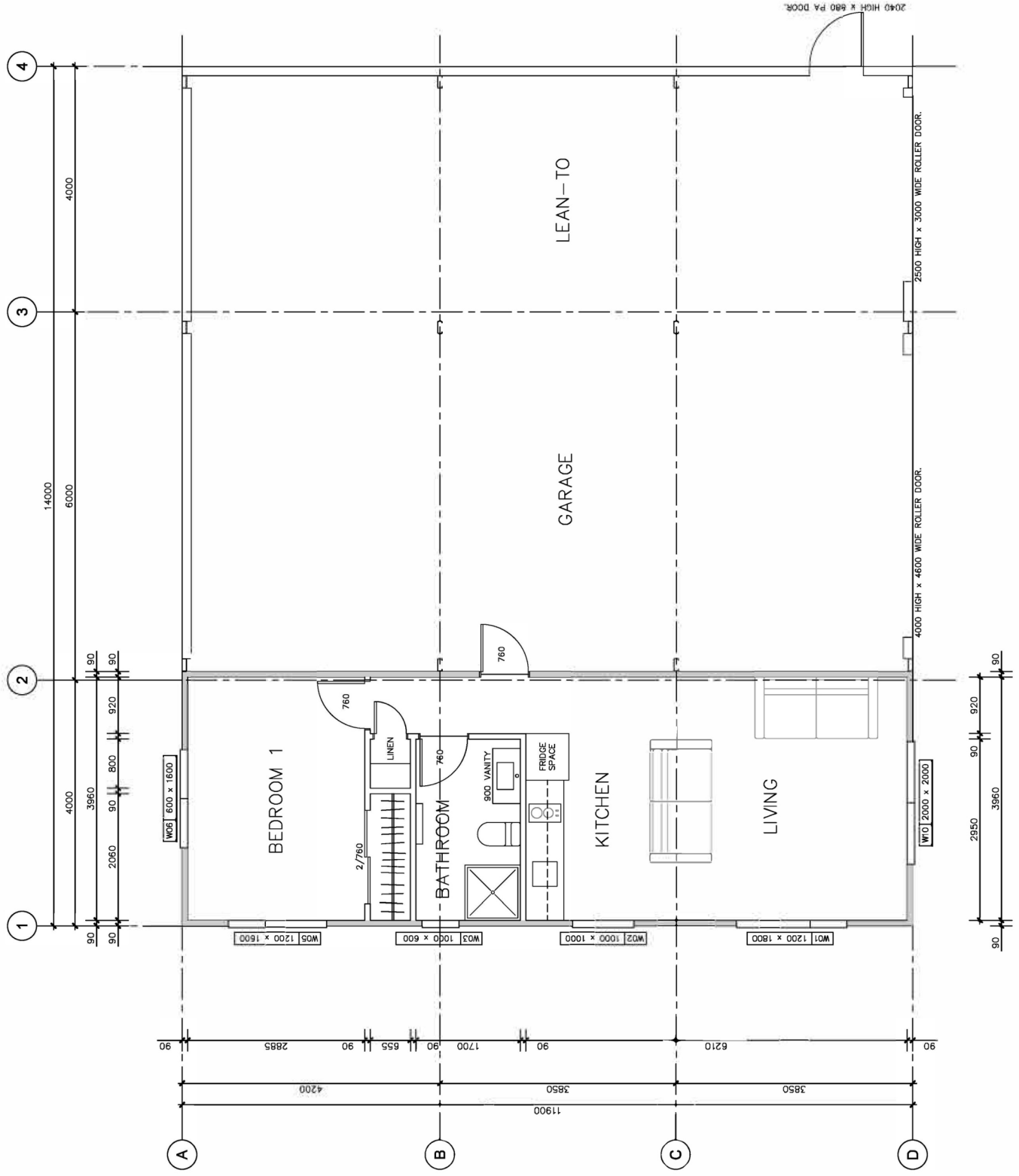

# American Barn House - 1 Bedroom

